

D.I.WIRE PRO

BY PENSALABS

INTRODUCING THE D.I.WIRE PRO, our newest CNC wire bender, offering the kind of power, speed, and precision that professionals never thought possible from a bench top machine.

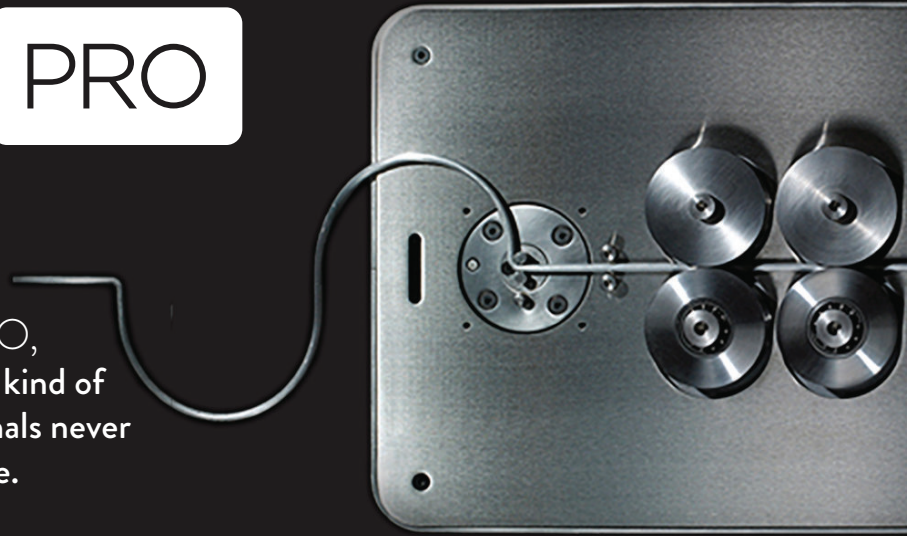

WHAT CAN THE D.I.WIRE PRO DO FOR ME ?

D.I.Wire PRO bridges the gap between time-consuming hand-bending and expensive large-scale, mass production CNC wire bending.

- **INCREASE PRODUCTIVITY**
Achieve more throughput per person.
- **INCREASE ACCURACY AND REPEATABILITY**
Eliminate operator fatigue, error.
- **CAPTURES EXPERT KNOWLEDGE AND SKILL**
New employees are productive right away.
- **SAVE MONEY AND TIME**
Run small jobs yourself instead of contracting.
- **PERFECT PROTOTYPE**
Before setting up a large production machine.

The bend mechanism delivers smooth, tight radius curves for wire as fine as orthodontic retainer wire, or up to stainless steel rod, applicable for jets, cars, home appliances, furniture, robotics and more.



Availability - Order now, shipping begins early 2017.

Contact - For more information or to place an order, please email sales@pensalabs.com

BASIC TECH SPECS

Capabilities & Requirements

WIRE CAPABILITIES

Wire diameters: from 0.018" (0.45mm) to 0.216" (5.5mm).

MATERIALS

A range of materials, from stainless steel to high carbon steel, low carbon steel, copper, brass, and aluminum.

SOFTWARE

Software included: use SVG files, G-code, or script using Feed/Bend commands. You specify tooling based on application and wire diameter.

POSITION ACCURACY

Feed: +/- 0.016" (0.4mm)

Bend Pin: +/- 0.5°

Feed rate: about an inch per second

MACHINE

Dimensions: 16.25" x 11.25" x 13" (41 x 29 x 33 cm)

Weight: 100 lbs (Shipping Weight: 125 lbs)

Operating Temperature: 15-30°C, 59-86°F

Power Req: 100-240 V, 1.8 A, 50/60 Hz

HOW DOES IT WORK?

The workflow for D.I.Wire PRO is simple and straightforward.



1 DRAW CURVE

Use any 2D vector creation software to design your shape. Create SVG from your CAD or design in Wireware.

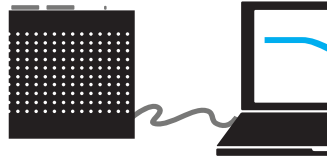

2 CONNECT VIA USB & OPEN WIREWARE

Connect D.I.Wire PRO and computer via USB and open Wireware to start a new bend project or open saved bends.

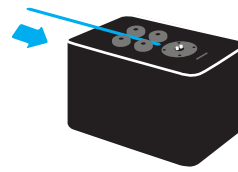

3 LOAD WIRE

Load your wire. DIWire PRO allows you to create custom material profiles that compensate for each material's properties.

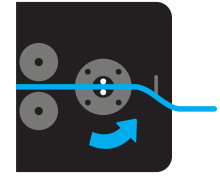

4 BEND

DIWire PRO makes bump bends, smooth curves, and 3D bends using manual rotations.

HOW DO I USE WIREWARE?

The software allows for direct control from a machine level up via a GUI or G-code, including custom calibrations and compensation controls.

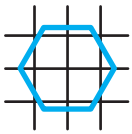

PATH MODE

Import an SVG file and manipulate it using an interactive interface: scale, adjust lengths and angles, or visually tweak your shapes.



SCRIPT MODE

Script mode lets you program shapes using our script commands in conjunction with your own material profile, or control the machine directly using G-code.



CALIBRATION MODE

Wireware lets you create and save custom calibrations for your materials and compensate for their properties.

HOW IS THE D.I.WIRE PRO DIFFERENT FROM THE D.I.WIRE?

The D.I.Wire PRO is designed with professional applications in mind.

- **MORE POWER:** bend stainless steel up to 0.188".
- **MORE MATERIAL OPTIONS:** customizable for wire sizes from 0.028" to 0.188", aluminum, brass, variety of steels, jacketed, and more.
- **MORE SHAPE CAPABILITIES:** bend up to 180° with close parallels; smooth curves can be coded for repeatability, sharper inside radii.
- **MORE OPTIONS FOR MATERIAL PROFILES:** customizable bend pins, mandrels, and more; can work with round or rectangular wire, and customizable for strap or tube.